

GT 6 L Z19

SELF-DRILLING SCREWS WITH WASHER FOR SHEET-WOOL-SHEET SYSTEM FIXING

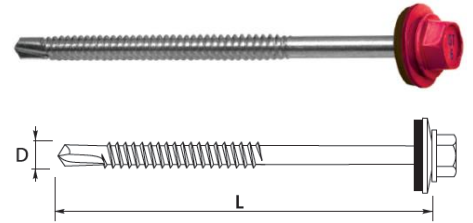

PRODUCT DESCRIPTION

Self-drilling, self-tapping screws made of surface-hardened carbon steel, electro-galvanized, drilling point #3, with fine thread and hex head, with integrated steel washer with vulcanized EPDM layer.

APPLICATION

Designed for fixing the steel sheet-wool-steel sheet system to steel structures.

Protected with paint coating - polyester thickness of not less than 50 µm, intended for use in environments with corrosivity class C1, C2 and C3 according to PN-EN ISO 12944-2: 2001 standard.

Galvanized without paint coating intended for use in environments with corrosivity class C1, C2.

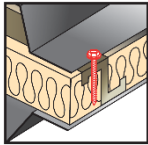

LENGTH OF SCREWS

Fastener type		Dimensions D x L [mm]	Maximum drill capacity [mm]	Maximum thickness of fixed elements [mm]	
			DC	MTmin	MTmax
GT 6 L	Z19	6,3 x 60	6,00	-	39
GT 6 L	Z19	6,3 x 80	6,00	-	59
GT 6 L	Z19	6,3 x 100	6,00	40	79
GT 6 L	Z19	6,3 x 120	6,00	60	99
GT 6 L	Z19	6,3 x 140	6,00	80	119
GT 6 L	Z19	6,3 x 160	6,00	100	139
GT 6 L	Z19	6,3 x 180	6,00	120	159

The working length of the connector is calculated from the maximum thickness of the DC substrate

NATIONAL TECHNICAL ASSESSMENT ITB-KOT-2018/0680

CHARACTERISTIC LOAD BEARING CAPACITY FOR SHEAR AND PULL-OUT RESISTANCE IN A STEEL BASE

Substrate thickness ¹⁾ [mm]		2,50	3,00	4,00	5,00	6,00	7,00	Wood class ≥ C24	
$M_{t,nom}$		7 Nm							
Attachment thickness ²⁾ [mm]	SHEAR [kN]	0,75	2,10	2,10	2,10	2,10	—	—	/
		1,00	3,60	3,60	3,60	3,60	—	—	
		1,25	4,35	4,35	4,35	—	—	—	
		1,50	6,15	6,15	6,15	—	—	—	
		2,00	10,50	10,50	10,50	—	—	—	
		3,00	11,30	11,30	—	—	—	—	
	FOR PULL OUT [kN]	0,75	5,10	5,10	5,10	5,10	—	—	
		1,00	5,10	5,10	5,10	5,10	—	—	
		1,25	5,10	5,10	5,10	—	—	—	
		1,50	5,10	5,10	5,10	—	—	—	
		2,00	5,10	5,10	5,10	—	—	—	
		3,00	5,10	5,10	—	—	—	—	

¹⁾ steel grade S280GD, S320GD or S350GD according to PN-EN 10346:2015

²⁾ steel grade S280GD, S320GD or S350GD according to PN-EN 10346:2015

If both elements I and II are made of steel grade S320GD, values $V_{R,k}$ can be increased by 8,3%

If both elements I and II are made of steel grade S350GD, values $V_{R,k}$ can be increased by 16,6%

OTHER FEATURES

BASE MATERIAL:	STEEL PROFILE
SIZE OF HEX HEAD:	8 mm
MINIMUM THICKNESS OF STEEL BASE:	2,50 mm
MAXIMUM CAPACITY OF DRILLING:	6,00 mm
THICKNESS OF ZINC COATING:	12 μ m
CORROSIVE ENVIRONMENT:	PAINTED - C3 UNPAINTED - C2
OPINION ON ANTI-CORROSIVE PROTECTION:	02248/16/Z00NZM
PAINTING POSSIBILITY:	YES
THICKNESS OF POLYESTER PAINT:	50 μ m
TIGHTENING TORQUE:	7 Nm
RECOMMENDED ROTARY SPEED (IDLE):	1500 rpm
DIAMETER OF STEEL WASHER Z19:	19 mm



KDWU



ZKP