

GTS-B

DRILLING, SELF-TAPPING
INSULATION SCREWS

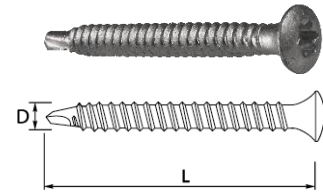

PRODUCT DESCRIPTION

Drilling, self-tapping screws made of surface-hardened carbon steel, with a reduced drilling point, fine thread, and bugle head with TORX25 slot. Covered with an additional gRey.coat corrosion protection coat.

APPLICATION

Designed for fastening insulation materials in applications of flat roofs in combination with a plastic tube or DVP washer for corrugated structural steel sheets (up to 2 x 1,25 mm). Designed for use in environments with corrosivity class C1, C2, C3, C4 according to PN-EN ISO 12944-2: 2001 standards.

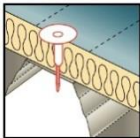

LENGTH OF SCREWS

Fastener type	Dimensions of fasteners D x L [mm]
GTS-B	4,8 x 50
GTS-B	4,8 x 60
GTS-B	4,8 x 70
GTS-B	4,8 x 80
GTS-B	4,8 x 90
GTS-B	4,8 x 100
GTS-B	4,8 x 110
GTS-B	4,8 x 120
GTS-B	4,8 x 130
GTS-B	4,8 x 140
GTS-B	4,8 x 150
GTS-B	4,8 x 160
GTS-B	4,8 x 180
GTS-B	4,8 x 210
GTS-B	4,8 x 240
GTS-B	4,8 x 280
GTS-B	4,8 x 300

NATIONAL TECHNICAL ASSESSMENT ITB-KOT-2018/0706

CHARACTERISTIC AND DESIGN LOAD CAPACITY ON AXIAL PULLING FROM SUBSTRATE [kN]
BY. AT-15-9718 / 2016:

Fastener type	Sleeve or washer	Substrate	Thickness of substrate sheet [mm]	Characteristic bearing capacity [kN]	Design load capacity [kN]
GTS-B	G	Steel grade S280GD	0,75	1,01	0,76
			0,88	1,11	0,76
			1,00	1,59	0,76
			1,25	1,59	0,76
	DVP	Steel grade S280GD	0,75	1,01	0,76
			0,88	1,11	0,76
			1,00	1,59	0,76
			1,25	1,59	0,76

Steel according to the norm PN-EN 10346:2015.

EUROPEAN TECHNICAL APPROVAL ETA-12/0149

CHARACTERISTIC LOAD CAPACITY OF PULL-OUT FIXINGS FROM STEEL SUBSTRATE

Characteristic load capacity of pull-out resistance [kN]								
Fastener	Sleeve or washer	Substrate						
		Steel sheet S280GD acc. to EN 10346						
		t ≥ 0,50 mm	t ≥ 0,63 mm	t ≥ 0,70 mm	t ≥ 0,75 mm	t ≥ 0,88 mm	t ≥ 1,00 mm	t ≥ 1,25 mm
GTS-B 4,8xL	G1, G2	-	-	1,08	1,08	1,11	1,59	1,59
	DVP	-	-	1,08	1,08	1,11	1,59	1,59

To define a design load should divide the value of the characteristic load by a safety factor $\gamma_m = 1,33$.

OTHER FEATURES

BASE MATERIAL:	TRAPEZOIDAL METAL SHEET
TYPE OF CUT:	TX25
ADDITIONAL CORROSION PROTECTION:	<i>gRey.coat</i>
CORROSIVITY CATEGORY:	C4
TECHNICAL OPINION ON CORROSION PROTECTION:	02248/16/ZOONZM
MINIMUM THICKNESS OF SHEETS:	0,70 [mm]
MAXIMUM CAPACITY OF DRILLING:	2 x 1,25 mm
RECOMMENDED ROTARY SPEED (IDLE):	1500 rpm
POSSIBILITY OF COMPLETE WITH:	PLASTIC SLEEVE G1, G2, DVP WASHER



ETA



DWU/DoP



KDWU



ZKP