

## SADDLE WASHER

SPECIAL ALUMINIUM WASHERS  
FOR SANDWICH PANELS FIXING

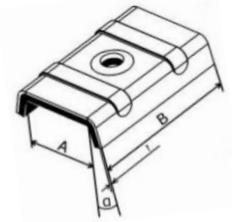

### PRODUCT DESCRIPTION

Calottes made of high quality aluminum with vulcanized EPDM layer.

### APPLICATION

Designed for fixing sandwich panels by means of GTR SP screws. Calottes increase the capacity of the connection thanks to larger contact surface area with the lining of sandwich panel. While vulcanized EPDM material provides excellent sealing properties and excellent flexibility.

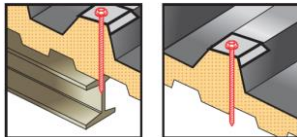

### DIMENSIONS

Type	Dimensions		
	Wave width A [mm]	Length B [mm]	Inclination angle $\alpha$ [°]
PKAL2627	26	41,5	27
PKAL3225	32	41,5	25
PKAL4132	41	41,5	32

### TECHNICAL APPROVAL ETA 13/0199

Type	Characteristic bearing capacity*
	To drag connectors through calottes washers
PKAL2627	7,88 kN
PKAL3225	7,88 kN
PKAL4132	7,88 kN

\*- Full characteristic load available in ETA 13-/0199 annex: 67-74.

## CHOOSING CALOTTES FOR SANDWICH PANELS OF SELECTED MANUFACTURERS:

Manufacturer	Sandwich panels type	Size		Manufacturer	Sandwich panels type	Size	
		A	α			A	α
Arcelormittal	Ondatherm 1001 T	26	27	JORIS IDE	Jl 45.333.1000	26	27
	Promisol 1040 TS	26	27		Jl Roof 1000	26	27
ALUBEL	Alubel 28	41	32	KINGSPAN	KS 1000 FF	26	27
	Alubel 40	41	32	KLOCKNER	KAS AL.- 20/125 A	41	32
	Alutech Dak	26	27		KAS AL.- 30/153 A	26	27
ALUFORM	Aluform 20/125	41	32		KAS - 35/207	41	32
	Aluform 45/150	26	27		KAS - 89/305	41	32
	Al utherm Dt 900	26	27		KAS - D 80	41	32
ARCELOR	39/333T	26	27	LAUKIEN	35-207	41	32
	AL 45/150	26	27		45-333 S	26	27
	Ondatherm 1001 TS	26	27	LINDAB	LP35	41	32
	Ondafibre 3005T	26	27	LUXMETAL	LM40 250 1000	26	27
	Agratherm 1001 TS	26	27	MAAS	35-207	41	32
BIEBER	20/125	41	32		45-150	26	27
	35/207	41	32		45-333 S	26	27
	8/307	41	32	Marcegaglia	PGB TD5	26	27
	89/305	41	32	MONTANA	SP 35	41	32
Barda	DACHOWA ALAMENTTI	41	32		SP 45	41	32
	DACHOWA EPS d	41	32	MUNKER	M 40K D/333	26	27
BALEX METAL	PWD	26	27	O-METAL	20.125/8	41	32
	BALEX THERM PU-R	26	27		40.250/4	26	27
DANSK PROFILTEKNIK	20-35	41	32		45.150/6	26	27
	20-65	26	27		45.333/3	26	27
	20-100	26	27	PLANNJA	PLANNJA 35	41	32
	35-115	41	32	PROGE	26/143	41	32
DS.	20-115	26	27		45/150	41	32
	35-190	41	32		90/305	41	32
	35-206	41	32	Ruukki	SP2C PUR	41	32
	22-270	26	27		SP2C PIR	41	32
FISHER	35/207	41	32		SPC W	41	32
	85/280	41	32	SAB	35R/1035	41	32
	DL 70; 80; 100; 120; 140; 160	41	32		89R/915	41	32
Gór-stal	GORLICKA D 1000	41	32	SALZGITTER	PS 35/207	41	32
	GORLICKA D 1000 GS-PIR	41	32		SIP D	41	32
HOFFMANN	35-207	41	32				

Manufacturer	Sandwich panels type	Size	
		A	α
SCHÜTTE ALUMINIUM	35-207	41	32
	20-125	41	32
	30-153	26	27
SIEGEMETALL	40/333	26	27
	85/280	41	32
ThyssenKrupp Steel Europe AG	Hoesh Thermodach	41	32
	T 85.1	41	32
TRIMO	SNV	26	27
Friedrich von Lien AG	W35-1035	41	32
Wurzer Profiliertechnik GmbH	WU 20/125	41	32
	WU 35/207	41	32
	WU 45/333	26	27
	WU 80/307	41	32

## OTHER FEATURES

MATERIAL OF METAL PART:	ALUMINIUM CA 5052
SEALING MATERIAL:	POLIMER P-36
DIAMETER HOLE IN METAL:	6,9 mm
DIAMETER HOLE IN EPDM:	4,0 mm
THICKNESS OF METAL:	1,0 mm
THICKNESS OF EPDM:	2,5 mm
MAXIMUM DIAMETER OF WASHER:	19 mm
CORROSION CLASS:	C5

