

## U-ZK

EXPANSION SLEEVES  
FOR CONCRETE

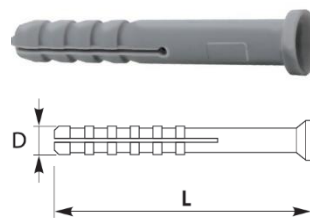

### PRODUCT DESCRIPTION

Nylon sleeves with a collar made of high quality polyamide.

### APPLICATION

Designed for fastening insulation materials on concrete in applications of flat roofs in combination with GTS-S screw. Long expansion zone ensures proper attachment even in lower grade concrete.

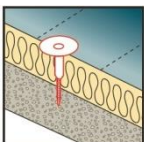

### LENGTH OF SCREWS

Oznaczenie	Wymiary wkreła D x L [mm]
UZ-K	8 x 60

### NATIONAL TECHNICAL ASSESSMENT ITB-KOT-2018/0706

CHARACTERISTIC AND COMPUTATIONAL LOAD CAPACITY ON AXIAL PULL-OUT FROM THE SUBSTRATE [kN]  
BY AT-15-9718/2016:

Fastener type	Sleeve or washer	Substrate	Anchorage depth [mm]	Hole diameter [mm]	Characteristic bearing capacity [kN]	Design load capacity [kN]
GTS-S + UZK	G	Concrete class min. C12/15*	60 (in the case of 50-60 mm thick channel plates - through assembly)	7,5	1,13	0,57
	DVP					

Concrete according to the norm PN-EN 206:2014

## EUROPEAN TECHNICAL APPROVAL ETA-12/0149

### CHARACTERISTIC LOAD CAPACITY OF PULL-OUT RESISTANCE

Characteristic load bearing capacity of pull-out resistance [kN]					
Fastener	Washer	Substrate			
		Concrete acc. To EN 206-1		Embedment depth [mm]	Drill hole diameter [mm]
		C12/15	C20/25		
GTS-S 4,8xL MQ 8x40	G1, G2	1,13	1,13	40,0	8,0
	DVP	1,13	1,13		
GTS-S 4,8xL U-ZK 8x57	G1, G2	1,13	1,13	60,0	8,0
	DVP	1,13	1,13		

To define a design load should divide the value of the characteristic load by a safety factor  $\gamma_m = 1,33$

## OTHER FEATURES

BASE MATERIAL:

CONCRETE, WOOD, FIBROUS-CEMENT BOARD

POSSIBILITY OF COMPLETE WITH:

GTS-S



ETA



DWU/DoP



DKWU



ZKP